



# MWS 18-12

## 12V 18Ah

### Compliance with standards

PN-EN 60896-21:2007  
PN-EN 60896-22:2007  
PN-EN 61056-1:2008  
PN-EN 61056-2:2003(U)  
PN-E-83016:1999

Batteries **MW Power** series **MW-S** are designed mainly for use in control panels charging systems . Thanks to profitable quality/ price relation, the batteries MW-S gained recognition of many clients. The batteries of this type can also be used as a source of charging in portable devices. Service life is 3-5 years for 20-25 °C .



### Specification

Nominal voltage		12 V
Nominal capacity		18,0 Ah
Dimensions	Lenght	181 mm
	Width	77 mm
	Height	167 mm
	Total height	167 mm
Weight		5,25 kg

### Dimensions

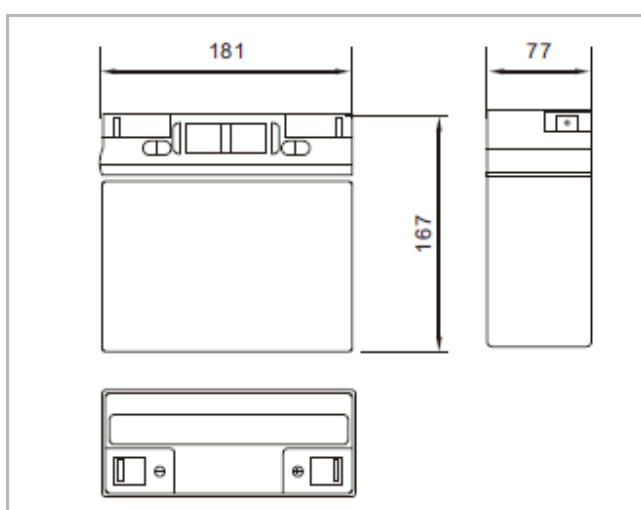

### Characteristic

Capacity for 25 °C and cut-off voltage 10.5 V	20h	18,0 Ah
	10h	15,8 Ah
	5h	13,5 Ah
Internal resistance	charged battery	17,0 mΩ
	for 20°C	100%
	for 0°C	85%
Capacity	for -15°C	65%
	3 m-ths	91%
Self-discharge	6 m-ths	82%
	12 m-ths	64%
Terminal	Insert M5 (T13)	
	Bolt and nut M5 (T3) – version F	
Charging	Standby use	13,50-13,80V
	Cyclic use	14,40-15,00V
Max. charge current	5,0 A	
Max. discharge current	160 A (5 sec.)	

### Input-discharge at 25 °C

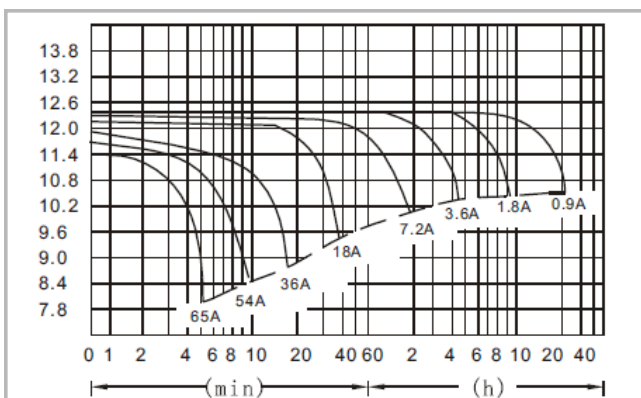

### Terminal

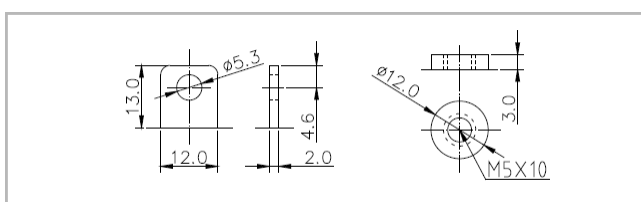

Temperatures of work:  
Discharging: -20°C ÷ 50°C  
Charging: -20°C ÷ 50°C  
Storage: -20°C ÷ 50°C



BIURO HANDLOWE: WARSZAWA UL. STANIEWICKA 14 TEL. 32 44 00 960 FAX 32 44 00 873 E-MAIL: [HANDEL@MPLENERGY.PL](mailto:HANDEL@MPLENERGY.PL)